

# ACESSÓRIOS - PORTÕES DE ABRIR

## Esquema de Montagem

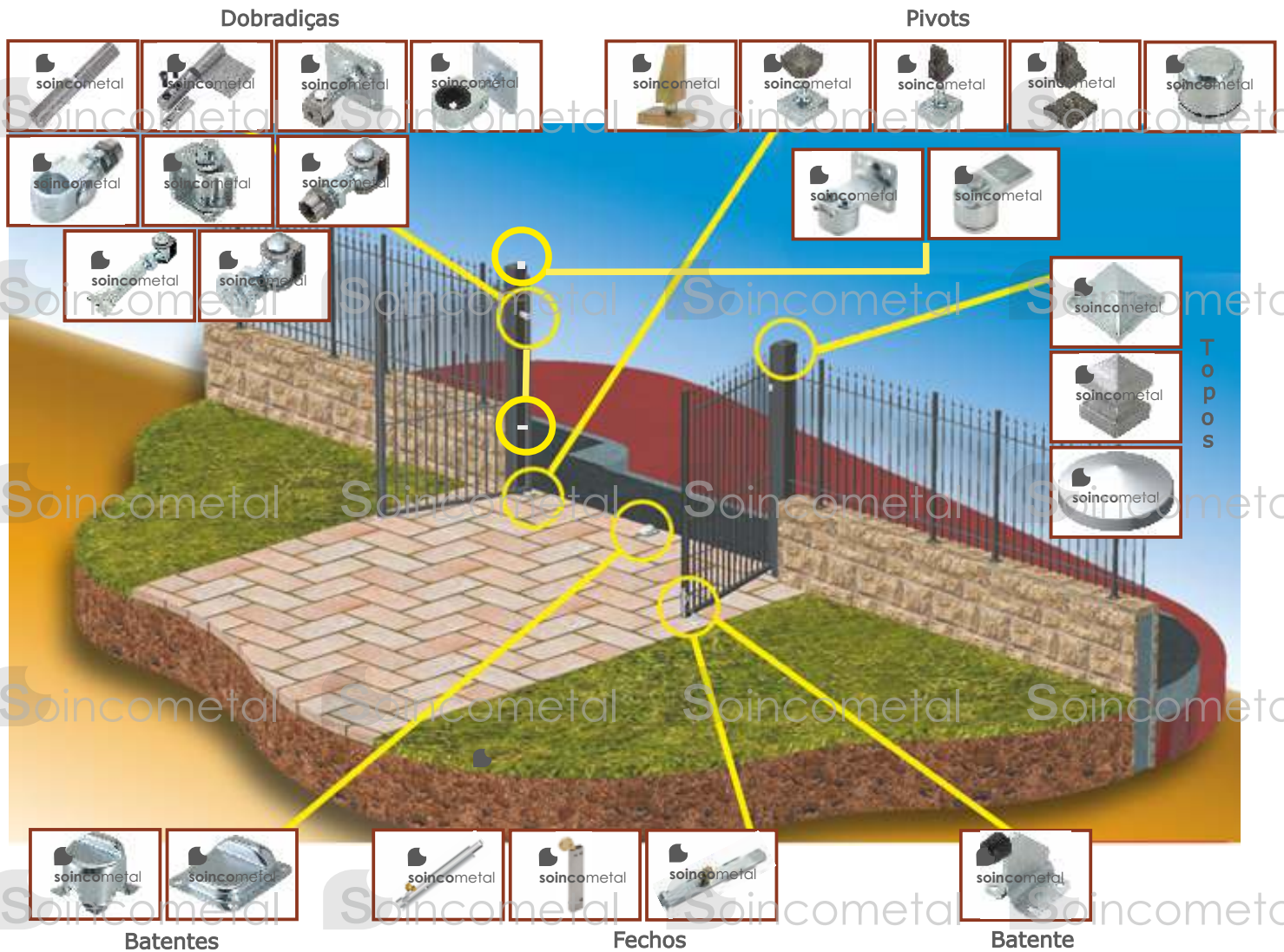

## 402

Dobradiça em chapa de duas abas

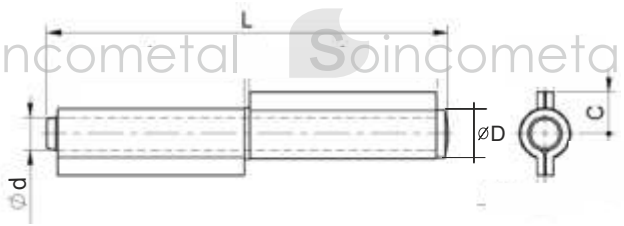

Referência	L	D	d	C	Qt. p/ caixa
402 60	60	10	5,5	8,5	48
402 80	80	12	8	10	48
402 100	100	13	9	11,5	24
402 120	120	14	10	12	24
402 140	140	16	11	13	24

## 410

Dobradiça em chapa de três abas

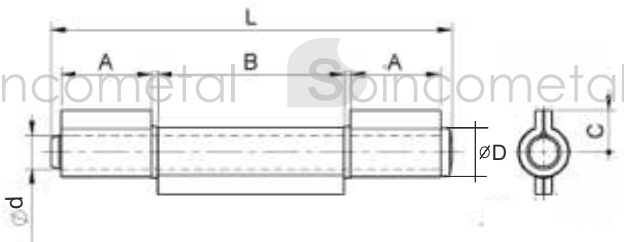

Referência	L	D	d	A	B	C	Qt. p/caixa
410 80	80	12	8	17	36	10	48
410 100	100	13	9	22	46	11,5	24
410 120	120	14	10	27	56	12	24
410 140	140	16	11	32	66	13	24

## 415

Dobradiça forte em chapa de três abas

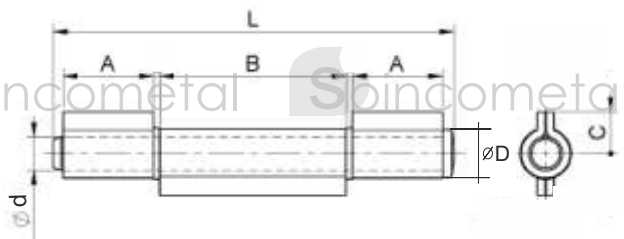

Referência	L	D	d	A	B	C	Qt. p/caixa
415 140	140	16	12	32	66	15	12
415 170	170	17	12	39	81	15	12
415 200	202	20	14	47	96	17	12

## 110

Dobradiça em chapa de duas abas c/ eixo fixo e topos

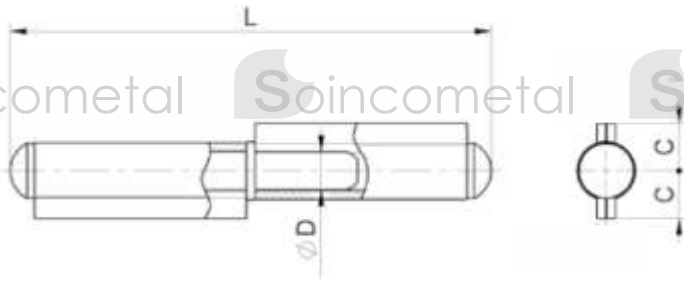

Referência	L	D	C	Qt. p/ caixa
110 60	64	6	8,5	48
110 80	84	8	10	48
110 100	105	9	11,5	24
110 120	126	10	12	24
110 140	149	11	13	24
110P 140	150	12	15	12
110P 170	180	12	15	12
110P 200	211	14	17	12

## 160

Dobradiça forte em chapa de três abas com eixo zincado, rolamento e lubrificação

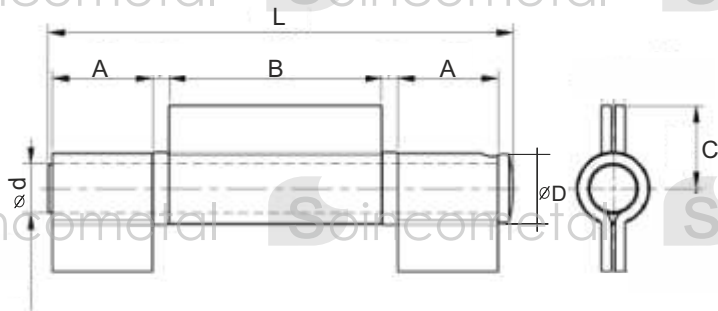

Referência	L	D	d	A	B	C	Qt.p/caixa
160	185	28	20	40	85	33	6

## 180

Dobradiça forte em chapa de duas abas com rolamento

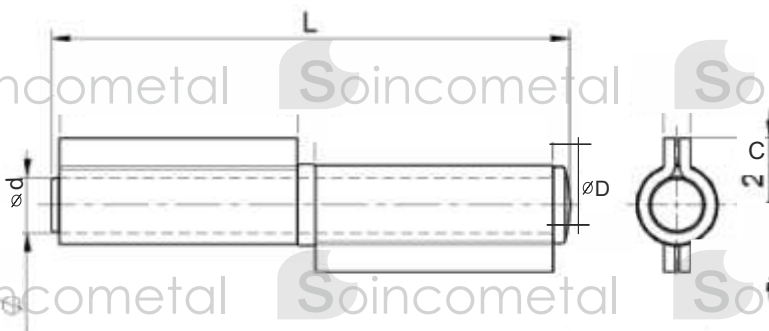

Referência	L	D	d	C	Qt.p/caixa
180 90	94	28	20	24	12
180 180	185	28	20	24	6

255

Dobradiça em perfil para soldar c/eixo zincado

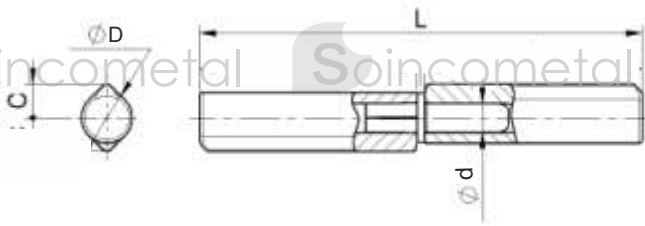

Referência	L	D	d	C	Qt. p/caixa
255 40	42	10	6	6,5	48
255 60	60	10	6	6,5	48
255 80	78	12	7	8	48
255 100	98,5	14	8	9	24
255 120	118,5	16	9	10,5	24
255 140	130	16	9	10,5	24



262

Dobradiça em perfil, com eixo zincado, e rolamento

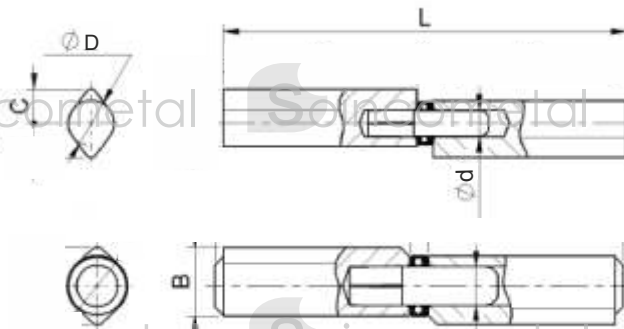

Referência	L	D	d	C	Qt. p/caixa
262 120	122	16	9	12	24
262 140	142	16	9	12	24
262 100	98,5	20	12	15	12
262 150	148,5	20	12	15	18
262 150/22	148,5	22	14	14	18
262 150/23	148,5	23	14	17	14
262 200/23	198,5	23	14	17	12



1254

Dobradiça estampada com eixo zincado e rolamento

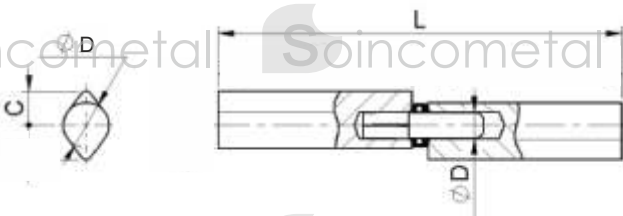

Referência	L	D	d	C	Qt. p/caixa
1254 100	98,5	20	12	15	12
1254 150	148,5	20	12	15	18
1254 150/22	146,7	22	14	16	18





## 240

Dobradiça c/abas, eixo e topos

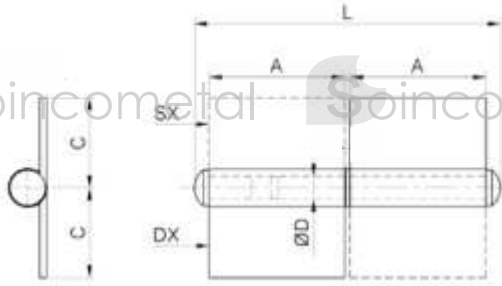

Referência	A	L	D	C	Qt. p/caixa
240DX/60	30	73	8	28	20
240SX/60	30	73	8	28	20
240DX/80	39	91	8	28	20
240SX/80	39	91	8	28	20
240DX/100	50	116	10	40	20
240SX/100	50	116	10	40	20
240DX/120	60	136	10	40	20
240SX/120	60	136	10	40	20
240DX/140	70	158	12	45	16
240SX/140	70	158	12	45	16
240DX/160	80	178	12	45	16
240SX/160	80	178	12	45	16

## 258 R

Dobradiça estampada c/perno em aço e rolamento

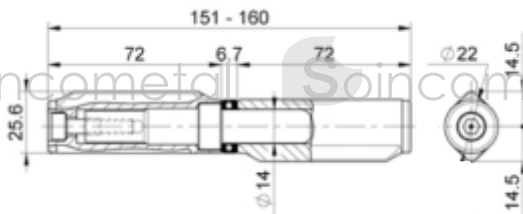

Referência	Qt. p/caixa
258 R	18

## 1258 R

Dobradiça estampada c/perno em aço e rolamento

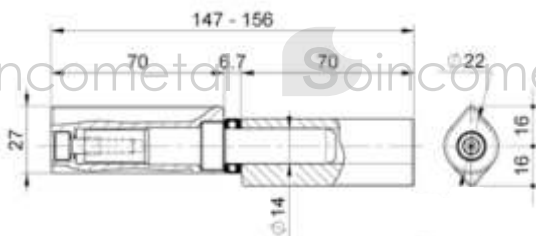

Referência	Qt. p/caixa
1258 R	18

## 263R

Dobradiça em perfil, regulável, com eixo zincado e esfera

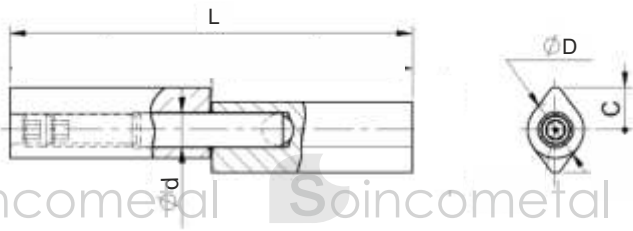

Referência	L	D	d	C	Qt.p/caixa
263 R	142-148	20	12	15	18

## 1214

Dobradiça regulável de eixo zincado com esfera para porta de segurança

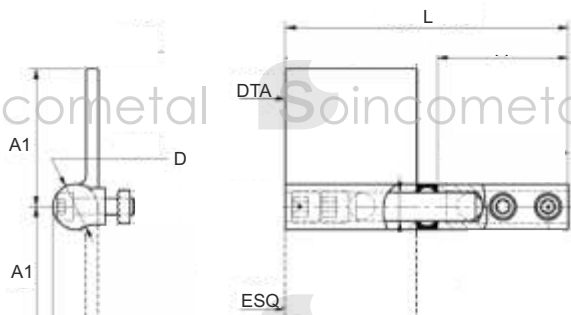

Referência	L	D	A	A1	Qt.p/caixa
1214 ESQ	135-145	22	64	67	10
1214 DRT	135-145	22	64	67	10

## 1208 R

Dobradiça de abas regulável de eixo zincado com esfera, para porta de segurança

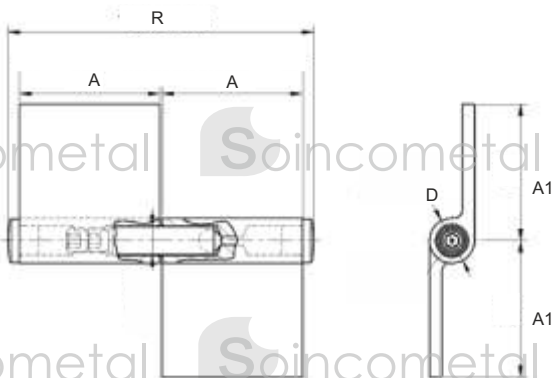

Referência	L	D Ø	A	A1	Qt. p/caixa
1208 R	149-155	22	69	67	10

## 1222

Dobradiça com mola incorporada

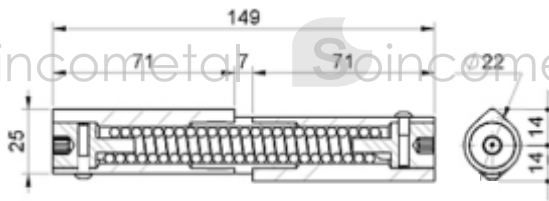

Referência Qt. p/caixa

1222 D	12
1222 E	12

## 111

Anilha rolamento

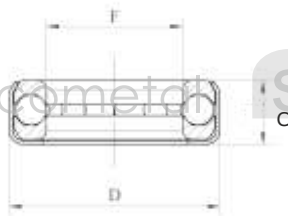

Referência F D C Qt. p/caixa

Referência	F	D	C	Qt. p/caixa
111/9	9	15	5,6	100
111/10	10	17,5	6	100
111/11	11	19	6,5	100
111/12	12	20	6,5	100
111/14	14	22	6,7	100
111/20	20	29	6,5	100

C

Dobradiça ajustável em aço para soldar

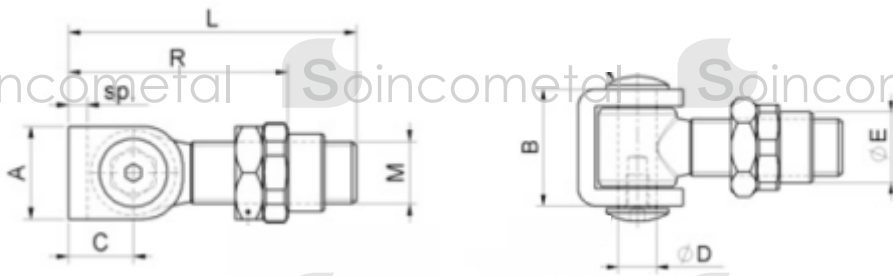

Referência	A	B	C	D	E	L	SP	M	R	Qt. p/caixa
C16	27	36	21	12	21	79	5	M16	52-68	12
C18	30	41	21	14	25	81	6	M18	57-68	12
C 20	30	41	21	14	25	92	6	M20	56-79	10
C 24	35	47	25	17	30	96	6	M24	67-80	6

CM

Dobradiça ajustável em aço com chumbadouro



Referência	A	B	C	D	E	F	L	Sp	M	R	Qt. p/caixa
CM 16	27	36	21	12	25	70	103	5	M16	46-60	12
CM 18	30	41	21	14	25	70	103	6	M18	49-62	12
CM 20	30	41	21	14	27	78	103	6	M20	48-73	10
CM 24	35	48	25	17	34	78	118	6	M24	58-77	6

CR

Dobradiça regulável em aço para soldar

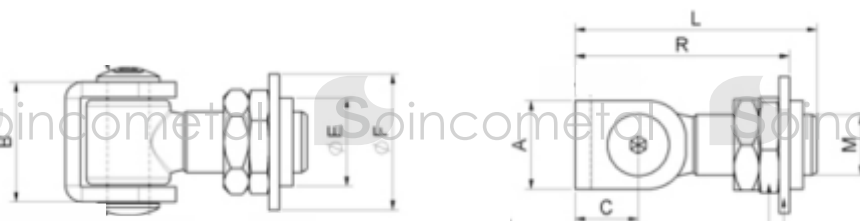

Referência	A	B	C	F	L	M	R	Qt. p/Caixa
CR 16	27	36	21	Ø46	79	M16	58-73	12
CR 18	30	41	21	Ø46	82	M18	62-76	12
CR 20	30	41	21	Ø46	92	M20	60-86	10
CR 24	35	48	25	Ø54	96	M24	70-90	6



## CRP

Dobradiça regulável com placa de fixação

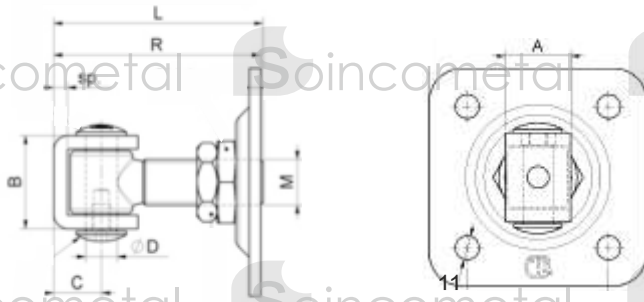

Referência	A	B	C	D ∅	L	SP	M	R	Qt p/caixa
CR16P	27	36	21	12	79	5	16	64-78	10
CR18P	30	41	21	14	81	6	18	68-70	10
CR20P	30	41	21	14	92	6	20	70-91	10
CR24P	35	48	25	17	96	6	24	77-95	8

## PR

Placa de fixação regulável

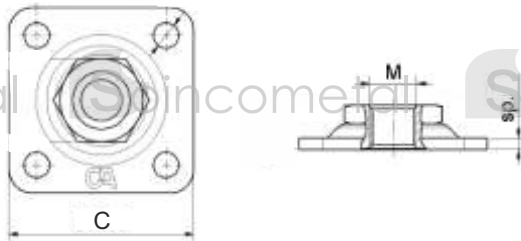

Referência	C	SP	M	Qt p/caixa
PR 16	80 x 80	5	16	10
PR 18	80 x 80	5	18	10
PR 18	100x100	5	18	10
PR 20	100x100	5	20	10
PR 22	100x100	5	22	10
PR 24	120x120	6	24	10
PR 27	120x120	6	27	10
PR 30*	120x120	6	30	10

## 379

Dobradiça ajustável com perno longo

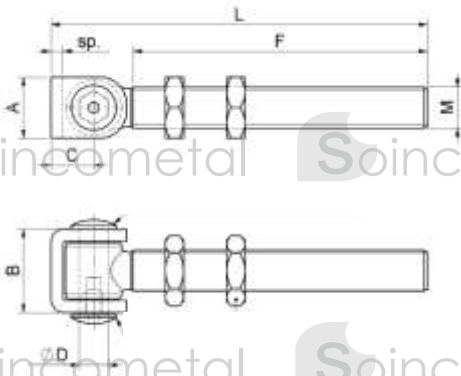

Referência	A	B	C	D ∅	F	L	M	SP	Qt p/caixa
379 18	30	41	21	14	140	178	18	6	10
379 20	30	41	21	14	142	185	20	6	10
379 24	35	47,5	25	17	141	190	24	6	6

CR 100 P

Dobradiça regulável para soldar

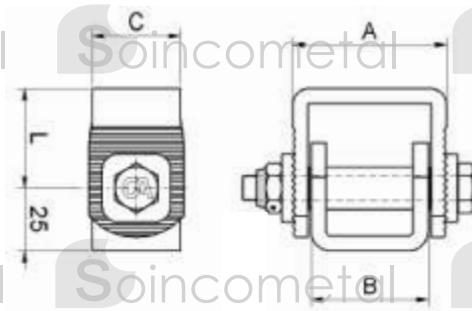

Referência	A	B	C	L	Qt.p/caixa
CR 100 P	44	30	30	31-42	12

371

Dobradiça regulável p/ soldar autoportante de rolamento

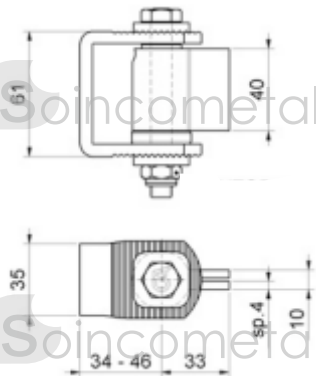

Referência	Qt. p/caixa
371	10

372

Dobradiça regulável p/ soldar autoportante de rolamento c/ placa

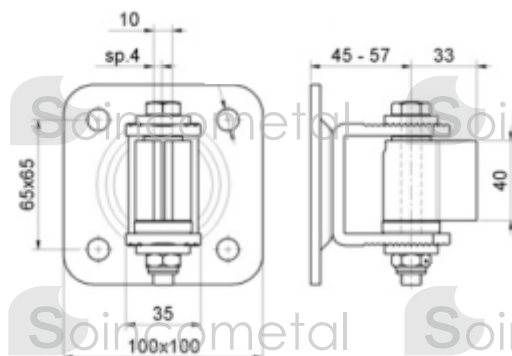

Referência	Qt. p/caixa
372	10

## Dobradiça ajustável para eixo torneado

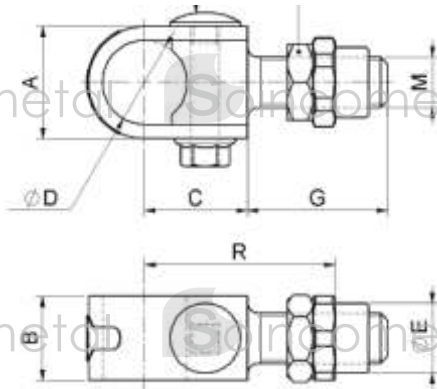

Referência	A	B	C	D	E	G	M	R	Qt. p/caixa
C 30	40	30	36,5	30	25	50	18	59-74	6
C 35	47	35	42,5	35	27	55	22	65-83	6
C 40	52	40	48,5	40	35	60	27	75-93	6

C



## Dobradiça regulável para eixo torneado

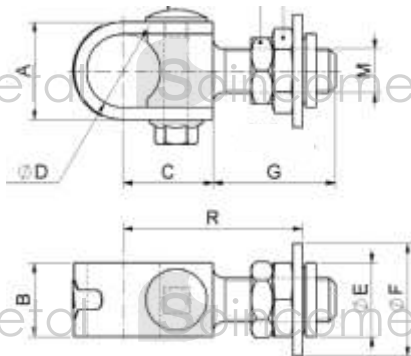

Referência	A	B	C	D	E	F	G	R	Qt. p/caixa
CR 30	40	30	36,5	30	30	46	64	63-92	6
CR 35	47	35	42,5	35	35	54	72	70-107	6

CR



## Eixo torneado

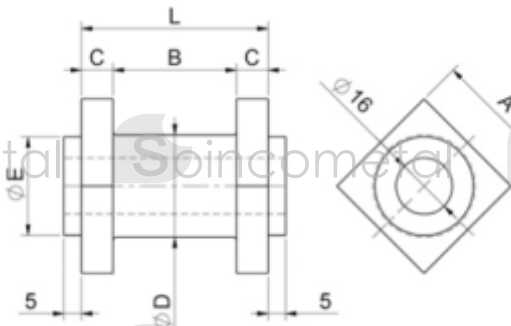

Referência	A	B	C	D	E	L	Qt p/ caixa
T 30	30x30	35	9	Ø29	Ø23	53	10
T 35	35x35	40	9	Ø34	Ø28	58	10
T 40	40x40	45	10	Ø39	Ø33	65	6

T



880

Dobradiça ajustável com perno longo

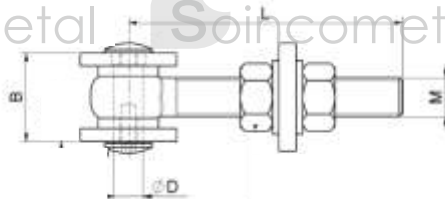
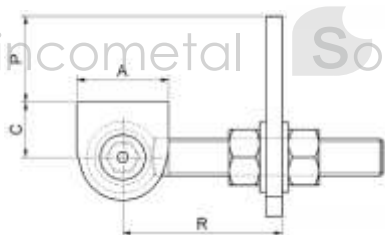

Referência	A	B	C	D	L	M	R	P	Qt p/caixa
880 12	45	34,5	24	12	100	M12	43-87	23-36	20
880 16	45	41	27	14	118	M16	58-115	27-43	10
880 20	70	47	35	17	135	M20	64-116	37-62	10

848

Dobradiça com placa e casquilho de nylon para tubo quadrado

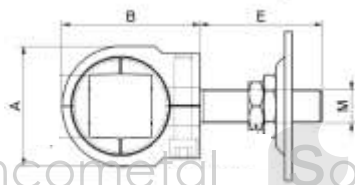
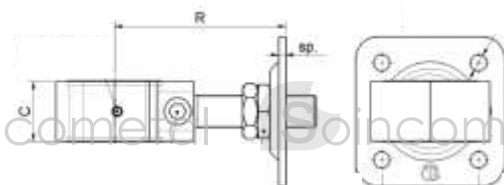

Referência	A	B	C	E	M	SP	R	Qt p/caixa
848/30	60	77,5	35	82	M22	5	77-127	4
848/35	70	84,5	35	82	M22	5	80-130	4
848/40	80	92	40	82	M22	5	85-135	4
845/ 30	60	77,5	35	82	M22	5	70-122	4
845/ 40	80	92	40	82	M22	5	77-129	4

Sem placa  
Sem placa

Pivot inferior com perno

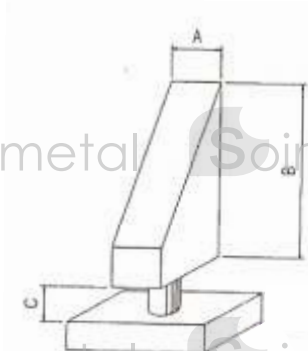

Referência	A	B	C	Qt. p/caixa
P 18	25	57	13	20
P 20	30	64	13	20
P 24	30	80	15	20
P 28	35	95	18	10





## 862 T

Placa e pivot redondo com esfera

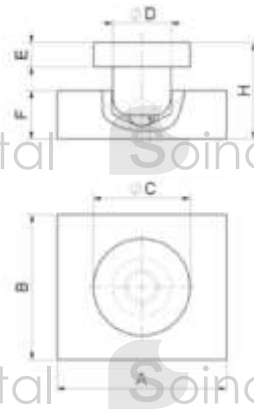

Referência	A	B	C	D	E	F	H	Qt p/caixa
862 T 30	70	60	30	24	10	20	38	6
862 T 35	70	60	35	24	10	20	38	6

## 862 R

Pivot inferior regulável

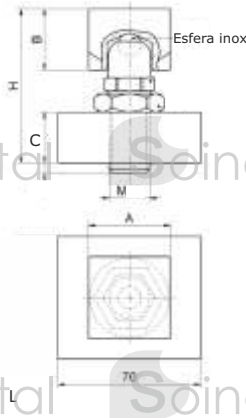

Referência	A	B	C	H	L	M	Qt. p/caixa
862 R /30	30 X 30	28	25	73-78	73-78	60	4
862 R/35	35 X 35	28	25	73-78	73-78	60	4
862 R/40	40 X 40	30	25	75-80	75-80	60	4

## 1500

Kit de pivot c/eixo retrátil



Referência	Qt. p/ caixa
1500/30x30	2

## 348

Perno para pivot

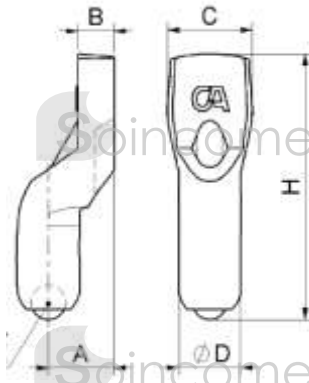

Referência	A	B	C	D	H	Qt.p/caixa
348 20	21	11	27	20	85	10
348 24	25	14	32	24	96	6
348 27*	28	15	40	28	103	10

\* Artigo até final de stock



## 349

Placa para pivot

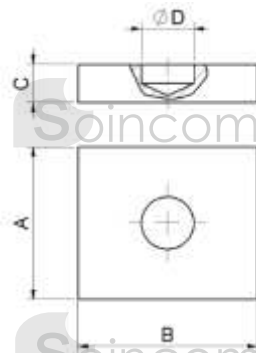

Referência	A	B	C	D	Qt.p/caixa
349 20	60	70	15	20,5	10
349 24	60	70	20	24,5	6
349 27*	79	80	20	28,5	10



## 349 PST

Placa p/ pivot

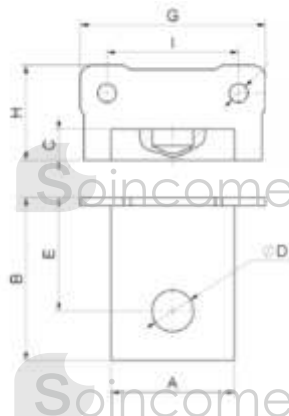

Referência	A	B	C	D	E	G	H	I	Qt.p/caixa
349PST/20	60	78	15	20,5	55	90	46	46	10
349PST/24	70	85	20	24,5	60	110	54	54	6
349PST/27	80	95	20	28,5	70	130	65	65	6



## 347 R

Pivot com esfera regulável

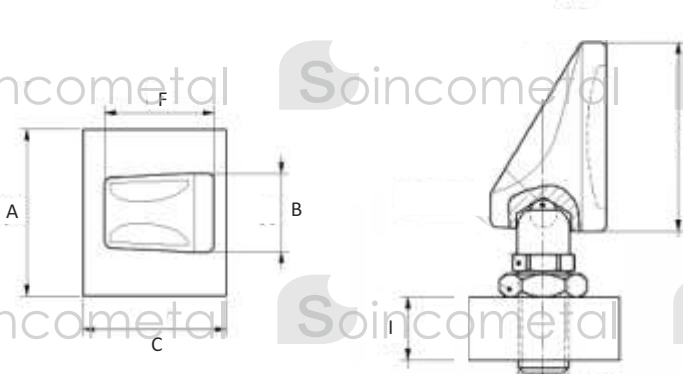

Referência	A	B	C	F	I	L	Qt.p/caixa
347 R	70	33	60	46	25	75	6

## 347

Pivot com esfera

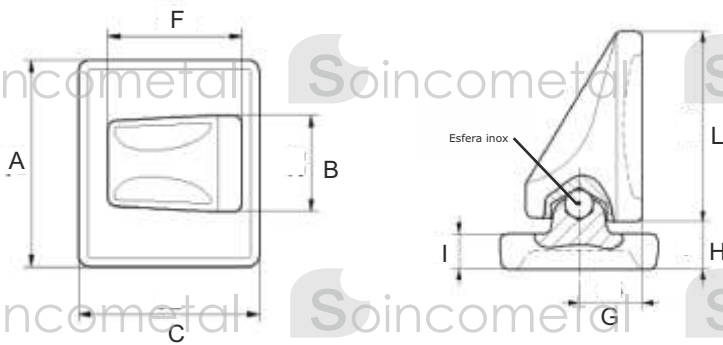

Referência	A	B	C	F	G	H	I	L	Qt p/caixa	
347	71	33	62	46	46	25	18	14	75	6

## PG I

Pivot inferior com rolamento cônico e grasser

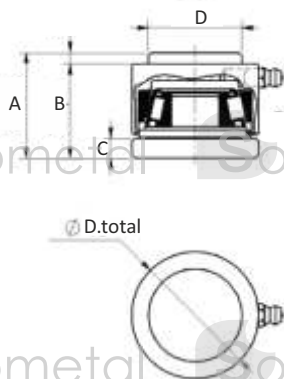

Referência	A	B	C	D	D.total	Peso Máx. Suport.	Qt p/caixa
PG 50 I	37,5	33,5	7	33	45	1200 kg*	4
PG 70 I	---	40	8	---	68	2000 kg*	4
PG 87 I	---	50	15	---	87	4800 kg*	2

\* Variável c/ dimensão e uso

## PG S

Pivot superior com rolamento e perno  $\varnothing$

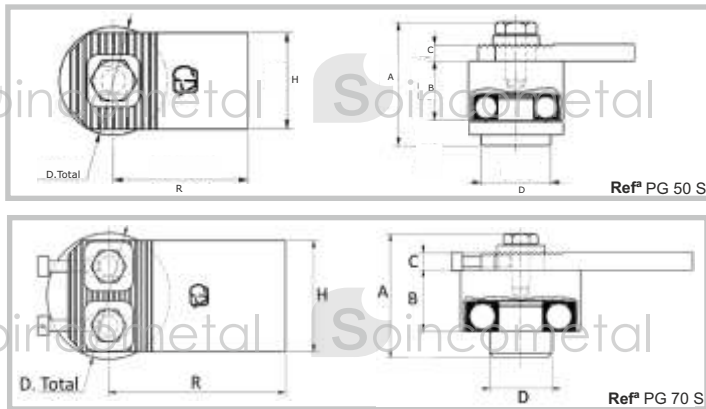

Referência	A	B	C	D	D.total	H	R	Peso suportado	Qt p/caixa
PG 50 S	58,5	28	8	33	45	40	52-60	1000 kg	4
PG 70 S	70	35	10	35	68	60	90-105	2500 kg	4
PG 87 S	97	55	15	50	87	100	126-137	500 kg - 2500 kg	2

## PG 50 SR

Pivot superior com rolamento e perno  $\varnothing 30$

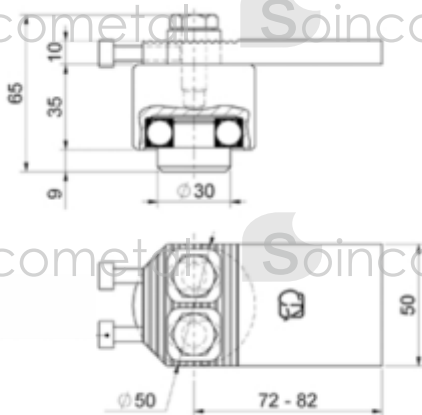

Referência	Qt p/caixa
PG 50 SR	4

## PG 50 SP

Pivot superior com rolamento, perno  $\varnothing 35$  e placa

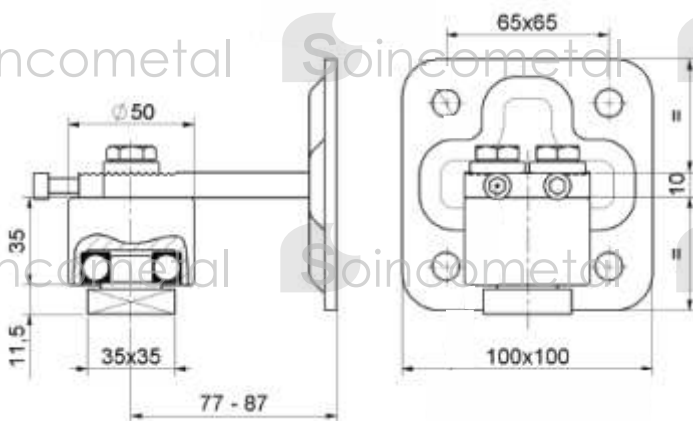

Referência	Qt p/caixa
PG 50 SP	4



## PG 70 SP

Pivot superior com rolamento, perno  $\varnothing 35$  e placa

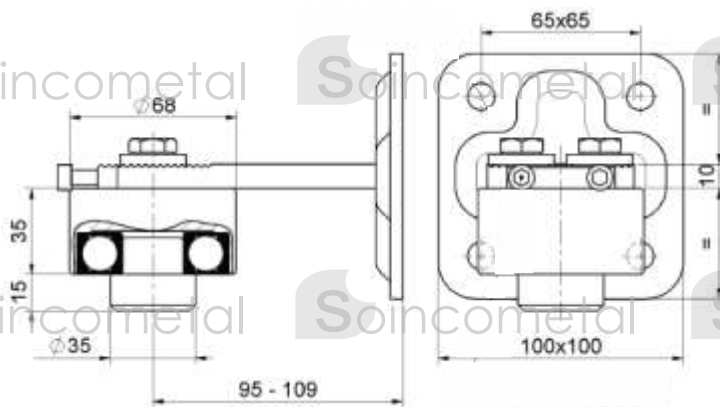

Referência Qt p/caixa

PG 70 SP 4

**380**

Batente de embutir

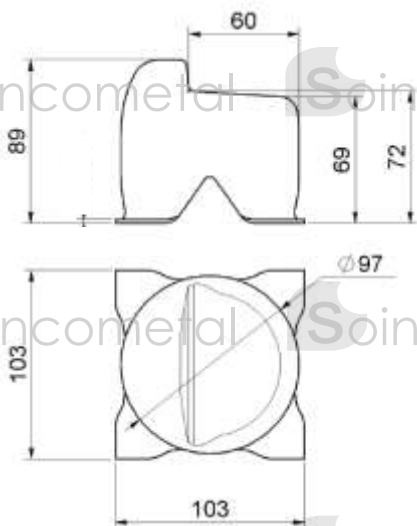

Referência Qt p/caixa

380 16

**380F**

Batente de aparafusar

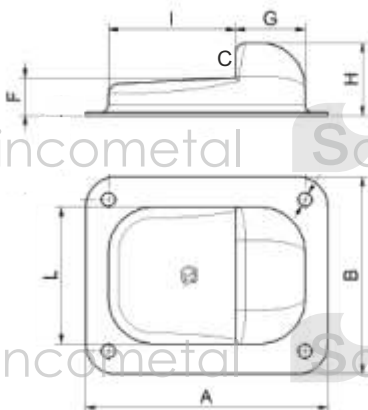

Referência A B C F G H L Qt. p/caixa

380 F PEQ 120 100 19 23 36 44 75 20

380 F 160 130 23 25 46 48 90 20

Fecho de bscula zincado

265

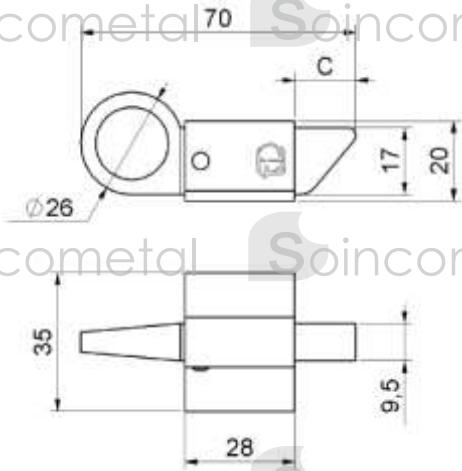

Referncia	Qt p/caixa
265	20

Fecho de bordo

220

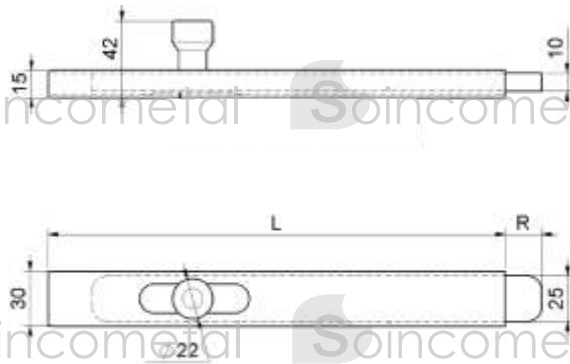

Referncia	L	R	Qt. p/caixa
220/ 200	200	0-43	10
220/ 400	400	0-53	10

Fecho de bordo

712/716

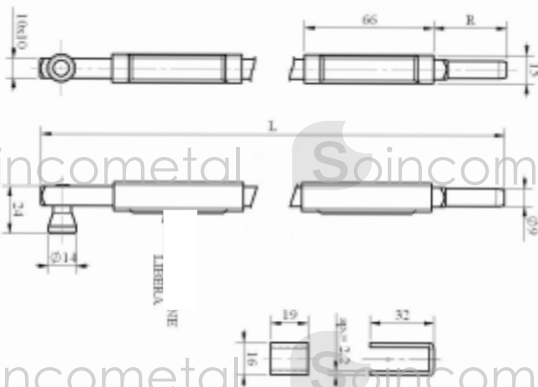

Referncia	L	R	Guias	Qt. p/caixa
712/ 130	130	2-40	n. 1	10
712/ 300	300	2-40	n. 2	10
716/ 300	320	-	n. 2	10

## Portões de abrir

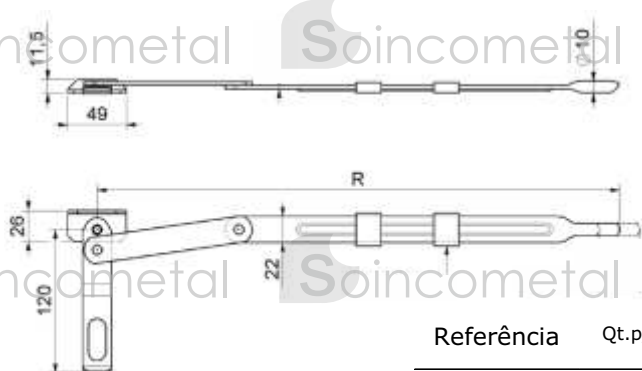
720/350  
Fecho de bordão articulado

Referência	Qt.p/caixa
720 / 350	10

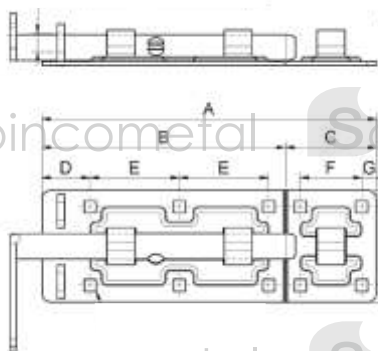
287  
Fecho de culatra p/aluquete

Referência	A	B	C	D	E	F	G	Qt.p/caixa
287 180	180	131	49	26	48	33	8	6
287 220	215	157	58	27	59	36	10	6
287 270	270	184	86	29	74	70	8	6

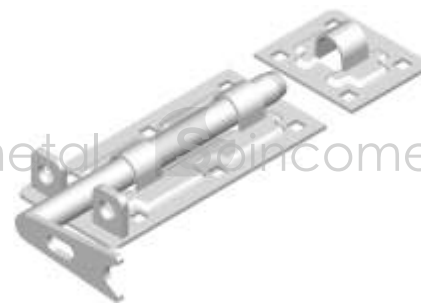
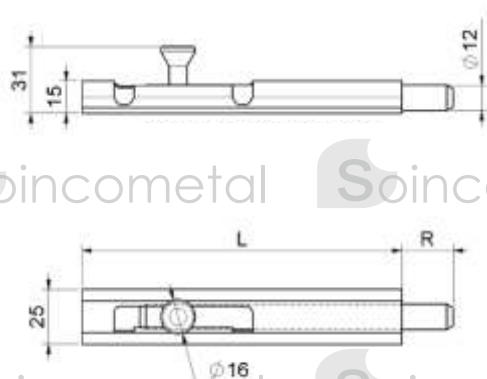
289  
Fecho de bordão

Referência	L	R	Qt.p/caixa
289 150	150	0-55	12
289 200	200	0-55	12
289 250	250	0-55	12
289 300	300	0-55	12
289 400	400	0-55	6
289 500	500	0-55	6



301

Fecho de Segunda folha de bola

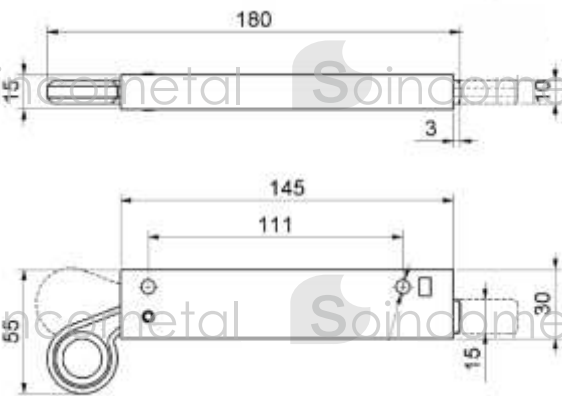

Referência	Qt. caixa
301	6

385

Cremone de alavanca

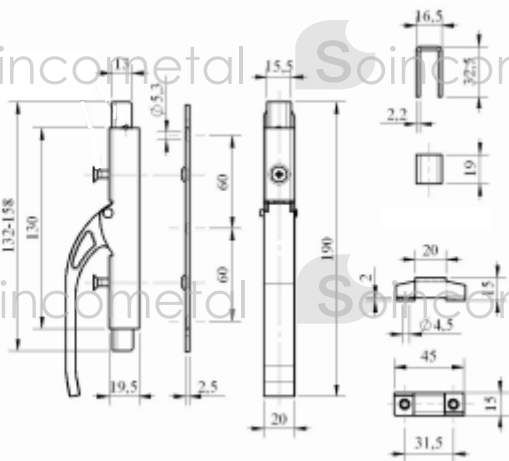

- Lacado preto;
- Para varão  $\varnothing$  10mm



Referência	Qt. caixa
385	6

5000

Fecho de alavanca

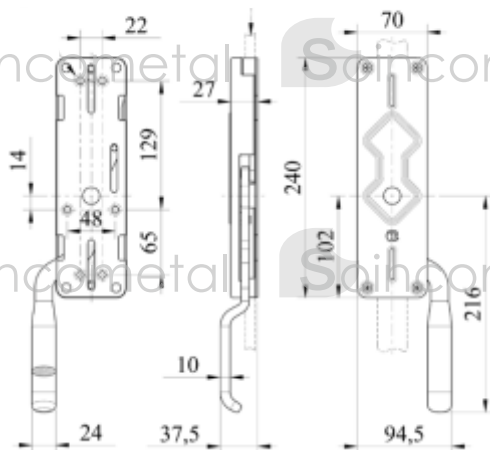

Referência	Qt. caixa
5000 D/E	2



222

Fecho de alavanca

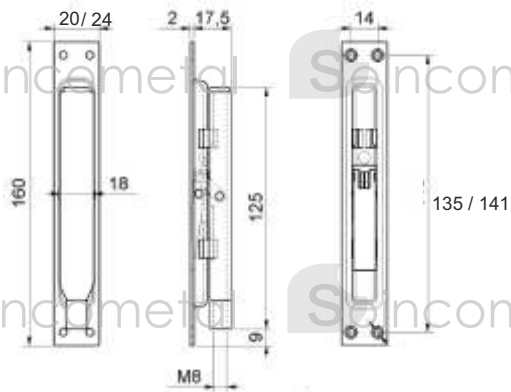

Referência Qt. p/caixa

222 16	10
222 20	10
222 24	10



390

Fecho de alavanca

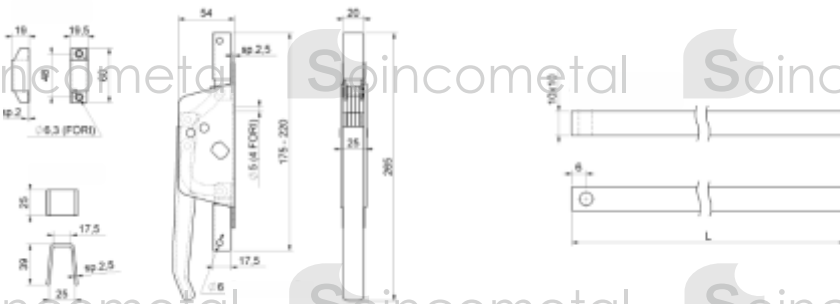

Referência Qt. p/ caixa

390	5
-----	---



391

Fecho de alavanca com chave

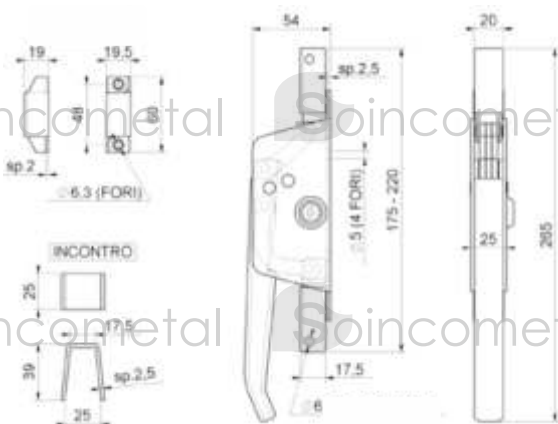

Referência Qt. p/ caixa

391	5
-----	---



## 232/233

Fecho interno e chave quadrada

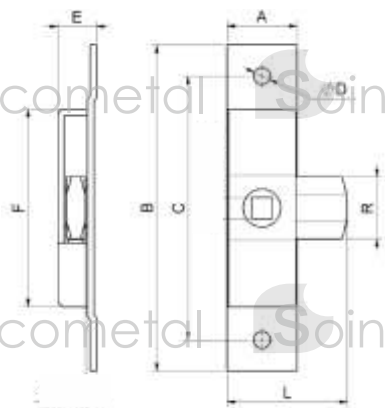

Referência	A	B	C	D	E	F	L	R	Qt. p/ caixa
232 PEQ	18	101	81	Ø5,3	12	64	34	6,5x18	20
232 GRA	27	126	102	Ø6,5	15	77	47	7,5x24	20
233	-	-	-	-	-	-	-	-	20

## 230

Fecho interior com chave quadrada

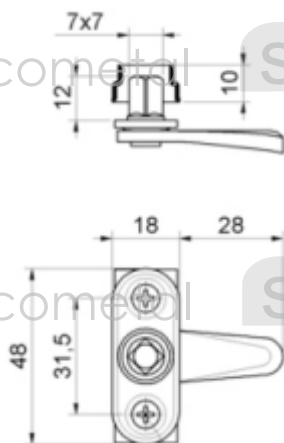

Referência	Qt. p/ caixa
230	50

**7750**

Adaptador para tubo redondo de 50mm



Referência	Qt p/caixa
77 50*	1

\* Artigo até final de stock

**78 50**

Chapa testas ajustável comlock



Referência	Qt p/caixa
78 50*	1

- Chapa testas para fechadura AFE 7450

\* Artigo até final de stock

Par de puxadores ajustável

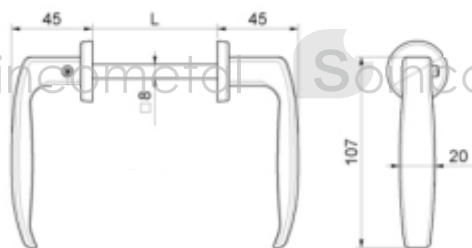

Referência

357

Par de puxadores em nylon

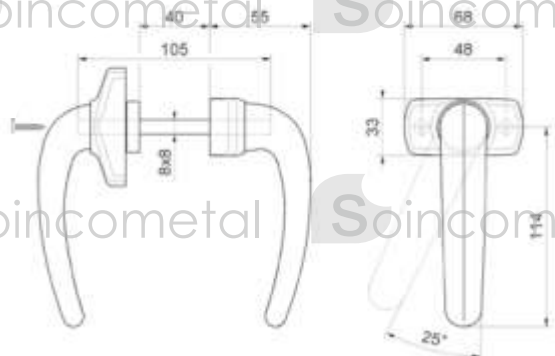

Referência

358

## 165

Topos para tubo quadrado zincado

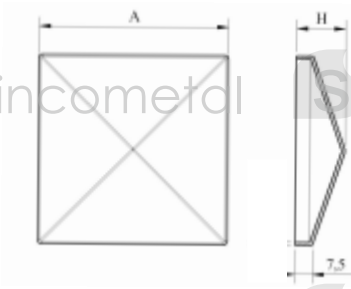

Referência	A	H	Para tubo	Qt. caixa
165/ 30	34	13	30	100
165/ 40	44	15	40	100
165/ 50	54	17	50	100
165/ 60	64	20	60	80
165/ 80	84	22	80	50
165/ 100	104	26	100	40



## 339

Capacetes para tubo quadrado s/ tratamento

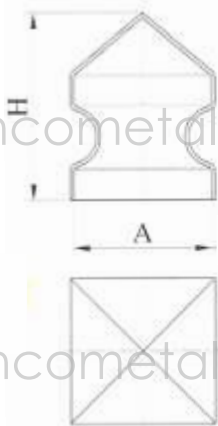

Referência	A	H	Para tubo	Qt. caixa
339/80	82 x 82	120	80	10
339/100	102 x 102	148	100	8
339/120	122 x 122	166	120	6
339/ 150	152 X 152	195	150	4



## 341

Topos para tubo redondo zincado

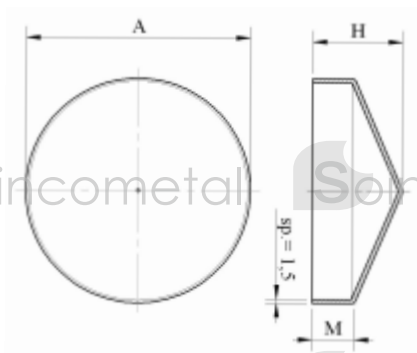

Referência	A	H	Para Tubo	Qt. caixa
341/42	Ø 46	21	Ø 42	100
341/48	Ø 52	28	Ø 48	100
341/60	Ø 64	30	Ø 60	70



\* Artigos até final de stock

Preços sujeitos a alteração sem aviso prévio

Os preços entendem-se à saída do nosso armazém e são acrescidos de IVA